



1617 Lockridge Loop E, Enumclaw, WA 98022

- » Beds: 4 | Baths: 2 Full
- » MLS #: 2461695
- » Single Family | 3,162 ft<sup>2</sup> | Lot: 8,429 ft<sup>2</sup>
- » More Info: [1617LockridgeLoopE.IsForSale.com](https://www.1617LockridgeLoopE.IsForSale.com)



**Gary Hendrickson**  
 Licensed Real Estate Broker  
 (253) 405-1099 (Cell)  
[garyh@gh1team.com](mailto:garyh@gh1team.com)  
<https://www.bhhsouthsoundproperties.com/>

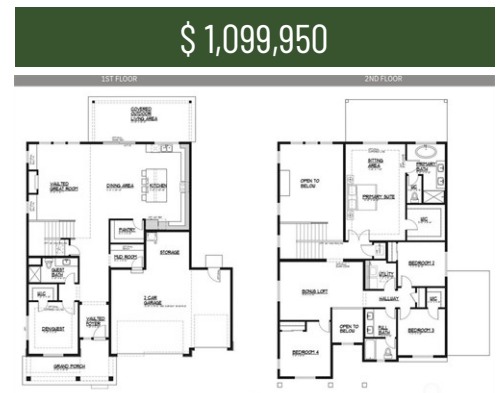

Boise Creek Cove in Enumclaw, a Fabulous New Home Community of 18 homes by Award Winning Builder, JK Monarch. Semi-Custom Built, Gorgeous 2-Story home featuring spacious 4 bedrooms, 3 baths plus a den/guest suite and 3-car garage. Stunning Upgrades include quartz counters, 8' doors, 5" base millwork & more. Great room w/tile surround fireplace flows to the Chefs kitchen featuring SS appliances, spacious island & soft-close cabinets. Partially fenced and front landscaping included. Enumclaw's newest community, where small-town charm meets modern living. Conveniently located to amenities plus a wonderful dog park close by! Presale, photos of similar home, colors & finishes may vary.

